

**SafeDial**<sup>TM</sup>  
*wireless*



**SafeDial**<sup>TM</sup> **Pocket**<sup>TM</sup>  
*toolbox* *Secure* 

 Powered by **PERMACONN**

## Features of SafeDial Wireless

### Features of the Globe SafeDial Wireless device include: -

- Multipath 4G and IP (model dependant) – Telstra SIM enabled.
- Four (4) hour integrity polling – Providing an ‘Always On’ health check.
- Simplicity – Simple installation with supplied antennae and software tools.
- Works with any Control Room (1345/1300 Option).
- No additional call charges – Low purchase price with fixed monthly cost.
- No GPRS receiver equipment required at the Control Room (1345/1300 Option).
- No extra monitoring fees as all events are reported to standard PSTN receivers, including equipment and poll fail messages.
- All alarm events and health checks exceptions are transmitted in Contact ID.
- Continuous online health checks and reporting of alarm panel (including watch dog reset timer), and dialler interface leads.
- Bureau focused activations providing total portability should you ever change Control Rooms.
- Ability to remotely interrogate (DC power, signal strength etc), testing and commissioning of all devices via a PC, tablet or smartphone using **SafeDial Toolbox (ATLAS)**.
- Ability to remotely arm & disarm Alarm Panels from your smartphone via the Pocket Secure App.
- Ability to remotely upload/download Alarm Panel configuration from your PC via SafeDial Config (PCS).
- Up to 14.4K band Modem for upload/download.
- Three (3) Outputs.
- Three (3) Inputs.
- Various LED status indicators for easy onsite diagnostics.
- The IP alarm panel interface acquires an IP address automatically using customer DHCP services.
- Non-volatile memory stores all setup information in the event of a power failure.



*Pocket Secure* is a smartphone application that allows the end-user to remotely arm and disarm their alarm system by connecting to the **SafeDial Wireless** servers via the internet.

The application displays the current status of the alarm system to the user and allows them an active view the history of their alarm panel activity. The *Pocket Secure App* has the ability to control multiple sites and partitions, and each site can have multiple users.

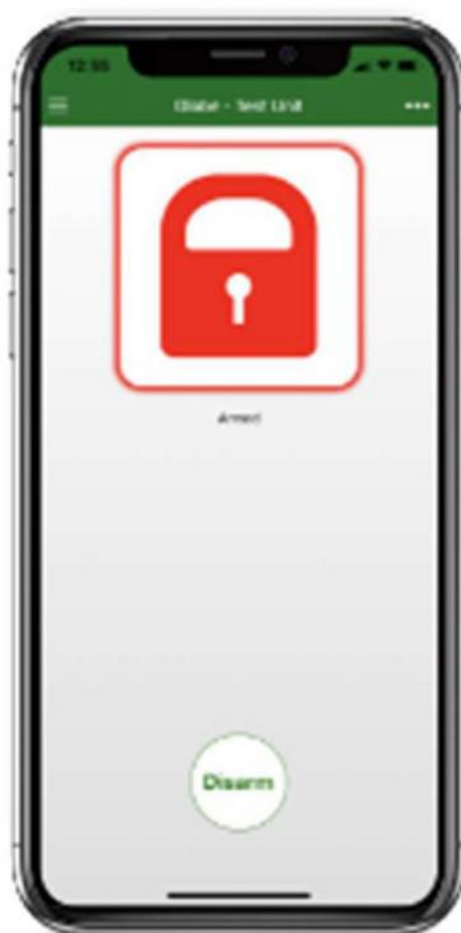

For information on wiring and set up of *Pocket Secure*, please refer to page 27 “Keyswitch Zone Wiring for *Pocket Secure*” of this handbook.

*Pocket Secure* is available from the ‘App Store’ & ‘Google Play’ application stores.

## Pocket Secure Features

*Pocket Secure* has a range of features that allow the user to remotely control and manage their alarm system.

With *Pocket Secure*, the user can:

- Arm and disarm their alarm system
- View the history of events from their alarm system.
- Control various locations such as their home and office from one application.
- Secure the app with a PIN code or fingerprint scanner.

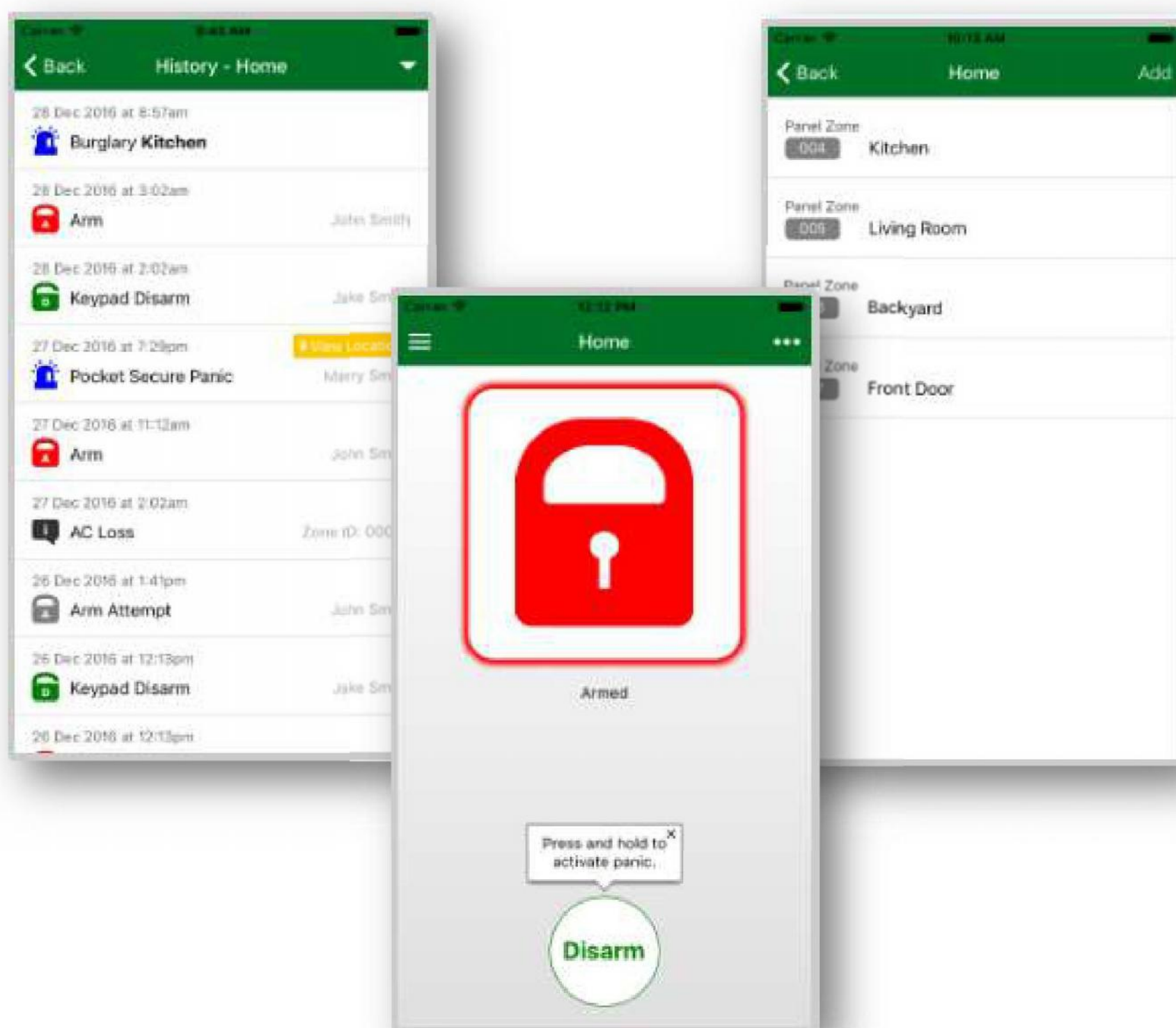

To toggle the state of the alarm, the app presents an interface to pulse output 1 on the **SafeDial Wireless** unit in the field. This then forces the app to wait until the next open/close event is sent and updates the app with the new state.

SafeDial Wireless is a unique Multi-Path 3G/IP wireless unit. The **only** full featured wireless unit that does not incur additional GPRS monitoring fees from your Control Room and is portable with your 1345 service.

SafeDial Wireless GL45-3G is the ideal solution to proactively target your existing customer base **before** the NBN rolls out. This is your opportunity to change marketing strategies, replenish your eroding call rebates and highlight to your customers the financial benefits of reducing PSTN charges.



## Features

- ✓ Telstra 3G/GPRS SIM
- ✓ 'Plug & Play' solution
- ✓ 4 hr simultaneous Integrity Polling on 3G & IP
- ✓ Compatible with ALL Control Rooms
- ✓ Interfaces with any Contact ID Alarm Panel
- ✓ Low ongoing operational costs
- ✓ Fully redundant network from customer premise to Control Room
- ✓ Portability with your 1345 number
- ✓ Remote Arm / Disarm **Pocket Secure™**
- ✓ Installation & Commissioning Tools **SafeDial Toolbox™**
- ✓ Remote Alarm Panel Upload / Download **SafeDial Config™**

## SafeDial Wireless™ – Intelligent Network



IP  
3G (4 HOUR POLLING)

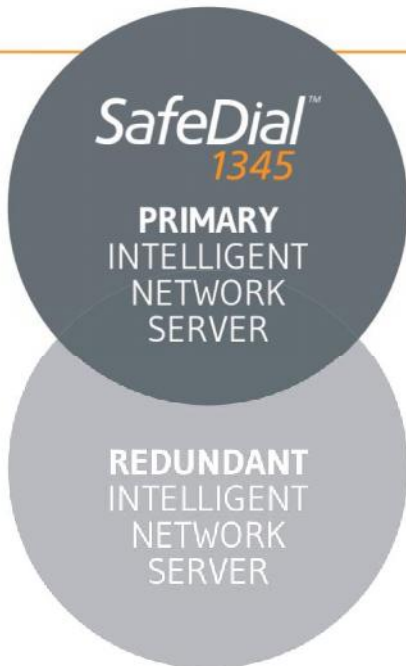

MULTIPLE PATHS OF COMMUNICATION



SafeDial™  
toolbox



Diagnostics and activation of SafeDial Wireless™

mySafeDial™



View call data and reports for all your SafeDial services

SafeDial™  
config 1010



Remote upload/download to your alarm panels

Pocket Secure™



Arm and Disarm from your smart phone

We know you'll love these handy features!

## SafeDial™ toolbox



### 'Your Remote Technician'

A web app providing activation, installation and diagnostics for installers. No guesswork – leave the site knowing the installation is complete and fully operational!

- ✓ Activate your units on-site.
- ✓ View the status and health of the unit.
- ✓ See event history and Contact ID messages.

## mySafeDial™



### 'Your Personal Manager'

A secure and powerful web portal providing access to your SafeDial call details and customised reporting. View call details for all SafeDial services –

- ✓ Last 6 months call details at a glance displayed in graphical format.
- ✓ See 'your' services and configuration details including control room and landing points.
- ✓ Run customised call reports for a whole month.
- ✓ SMS and email alerts are sent for alarm panels making excessive calls.

## SafeDial™ config 01010



### 'Your Remote Access'

A software application that allows the user to remotely connect their Alarm Panels upload / download configuration software via Globe's SafeDial Wireless network.

The solution effectively replaces the traditional phone line dialler solution and eliminates the need to visit customers' premises for Alarm Panel configuration changes.

## Pocket Secure™



### 'Your Remote Guard'

A downloadable app for smart phones providing remote arm / disarm functionality for your end users.

Ever left the office and forgot to arm the alarm? Not a problem, simply open Pocket Secure™ on your smart phone and secure your premises!

One app can be used for arming and disarming multiple locations – Home, Office or Holiday Home.

For more information and FAQ's on any of our products or services please visit us online at [www.globetelecom.com.au](http://www.globetelecom.com.au)

Phone 1300 73 73 14

Email [sales@globetelecom.com.au](mailto:sales@globetelecom.com.au)

*Pocket Secure* also offers customers an upgraded subscription service, *Pocket Secure Plus* with additional features and inclusions at an increased monthly charge to the end user (PayPal account required).

The variations between *Pocket Secure* and *Pocket Secure Plus* can be seen on below;

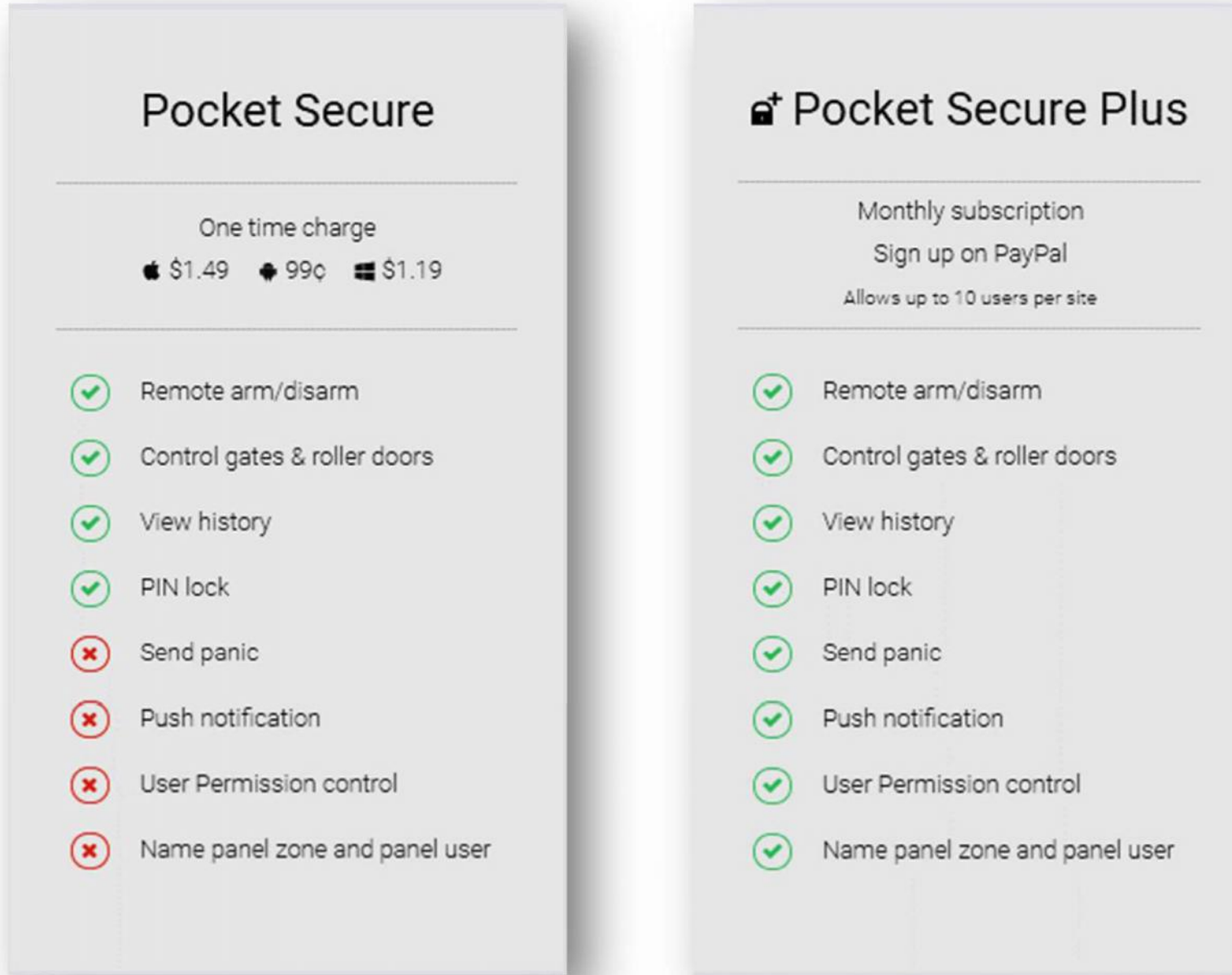

## **SafeDial on going cost \$20 a month Supplied and Installed @ \$295 inc GST**

\*\*A once off charge applies to the end user when downloading the Pocket Secure App. All data usage and once off charges are at the expense of the end user.

\*\*A monthly charge applies to the end user when downloading and subscribing to Pocket Secure Plus. All data usage and monthly charges are at the expense of the end user.